

**W Mount** (Shown in upright position) 1:8 Scale

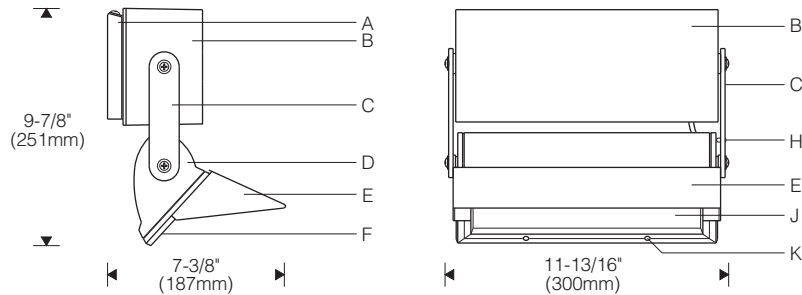

**S Mount** (Shown in prone position) 1:8 Scale

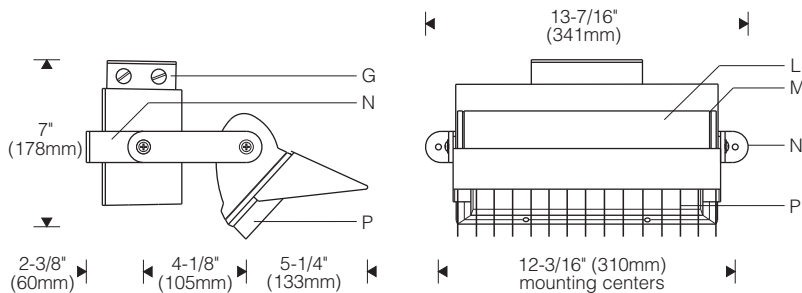

**Mounting Plate**

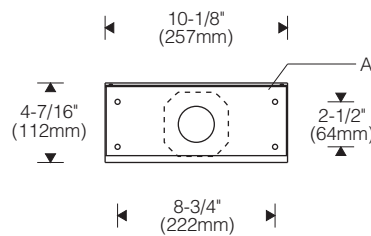

**F Mount: Slipfitter**

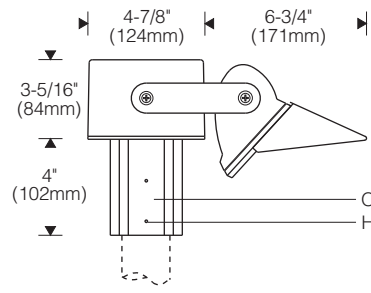

**Specifications**

- |   |  |  |   |
|---|--|--|---|
| <b>A</b> Stainless steel latch/hinge mounting plate (black) | <b>F</b> Mitred extruded aluminum door frame with silicone gasket            | <b>J</b> Micro-prismatic, thermal and impact resistant tempered glass lens | <b>M</b> Reveal plates (black)  |
| <b>B</b> Die-cast ballast housing                           | <b>G</b> Die-cast external splice compartment, (4) 1/2" NPT threaded entries | <b>K</b> Tamper-resistant captive door screws                              | <b>N</b> Aluminum mounting feet   |
| <b>C</b> Die-cast sidearms                                  | <b>H</b> Locking set screw   | <b>L</b> Specular extruded aluminum reflector                              | <b>O</b> Extruded aluminum slipfitter for 2-3/8" O.D. tenon or pole (by others) |
| <b>D</b> Die-cast end plates                                |  |  | <b>P</b> Accessory cross baffle   |
| <b>E</b> Cutoff visor (included)                            |  |  |   |

**Finish:**

Exterior surfaces - 6 stage pretreatment and electrostatically applied thermoset polyester powder coating for a durable abrasion, fade and corrosion resistant finish. Choice of semi-gloss colors (see ordering information).

Reflector - extruded high purity aluminum with clear anodized specular finish. All hardware and components - non corrosive stainless steel or aluminum. Door secured with captive tamper-resistant (#10 Torx) screws in stainless steel threaded reflector inserts to prevent seizing.

**Mounting:**

Sidearms can be rotated 90° in the field to position the reflector below or to the side of the ballast housing.

**W** mount - latch/hinge mounting plate fastens over recessed outlet box; suitable backing structure required (by others). Fixture hinges on wall plate for hands-free access to splices.

**S** mount - L-shaped mounting feet attach under sidearms. 9/32" dia. (7mm) clearance holes for 1/4" fasteners (by others).

**F** mount - slipfitter mounts over 2-3/8" O.D. pole, tenon or rigid conduit (by others).

**Electrical:**

Use 90°C wire for supply connections. Leads exit reflector and enter ballast housing through watertight flush cord entries and silicone coated fiberglass sleeving.

**S** mount - external splice compartment with four 1/2" NPT threaded entries. Liquidtight fittings and conduit by others.

**F** mount - 10" (254mm) leads exposed within slipfitter for splicing inside tenon or rigid conduit. For mounting atop pole higher than 8', specify **VS** option; see ordering information.

G12 lampholder for use with single ended lamp. Integral HPF high reactance autotransformer (HX-HPF) ballast rated for -20°F/-29°C starting. Optional electronic ballast with automatic shut-off to eliminate end-of-life cycling.

For complete ballast specifications, see Accessories Section.

**Standard:**

UL listed or CSA certified for wet locations.

**Features**

- Design flexibility - sidearms rotate 90°; choice of mountings
- Compact yet powerful - up to 150W ceramic metal halide
- Maximum peak candlepower for broad uniform coverage - controlled distribution minimizes "spill" or trespass light
- Durable - extruded aluminum reflector and door frame; die-cast end plates, sidearms and ballast housing

**Performance**

Two parabolic reflector sections drive light across the ground plane from one edge. An elliptical section redirects its light to a parabola and shields the lamp. Asymmetry is maximized resulting in high beam efficiency and superior surface uniformity. The fast "runback" minimizes wasted spill and trespass light. Wide lateral distribution permits greater spacings.

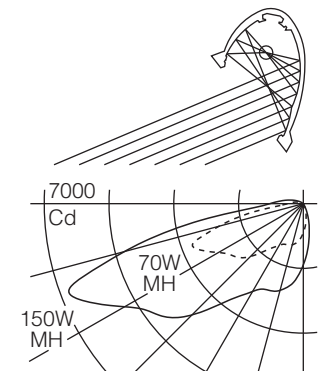

For complete photometrics, visit [www.elliptipar.com](http://www.elliptipar.com).



To form a Catalog Number

M | 4 | 5 | 2 | - | - | - | - | V | | |  
 1 | 2 | 3 | 4 | 5 | 6 | 7 | 8

1 Source

M = Metal halide

2 Style

452 = Small outdoor, integral ballast

3 Lamp

Lamp Code	Wattage	Lamp Number	Voltage(s)	Ballast
Ceramic Metal Halide* 				
035G	35	CMH35/T6/G12	A, B 1, 2	HX-HPF Electr.
070G	70	CMH70/T6/G12	A, B, H 1, 2	HX-HPF Electr.
150G	150	CMH150/T6/G12	A, B, H 1, 2	HX-HPF Electr.

For complete lamp and ballast information, see Accessories Section.  
 \* Metal halide lamps using ceramic arc tubes yield higher light output than lamps with quartz arc tubes. They offer improved lamp-to-lamp color consistency and a more stable color temperature over their life (±200K). Standard lamp color is 3000K / 80+ CRI.

4 Mounting

W = Latch/hinge mounting plate for recessed outlet box for wall mounting.  
 S = L-shaped feet for surface mounting. External splice compartment with (4) 1/2" NPT threaded entries.  
 F = Slipfitter for 2-3/8" O.D. pole, tenon or rigid conduit. For pole higher than 8' (2.4m), specify VS option code.

5 Finish

02 = Semi-gloss white      99 = Custom RAL or computer matched color to be specified, consult sales representative.  
 06 = Dark bronze  
 07 = Silver  
 08 = Semi-gloss black  
 12 = Green

6 Voltage/Ballast

Magnetic      Electronic  
 A = 120V      1 = 120V  
 B = 277V      2 = 277V  
 H = 347V (Canada)\*

\* 347V not available for 35W metal halide

Project: \_\_\_\_\_

7 Option (See Accessories Section for specifications)

V0 = Cutoff visor included, no other options  
 VR = Halogen standby lamp with integral relay. Lamp included (wattage varies).  
 VS = F mount with slipfitter for mounting on pole higher than 8' (2.4m). Supplied with 30' (9m) wire leads.  
 00 = Cutoff visor NOT included, no other options (Suggested when sconce enclosure or architectural detail will provide shielding of lens brightness.)  
 VX = For modification not listed, include detailed description. Consult factory prior to specification.

Note: Cutoff visor included unless specified otherwise.

8 Standard

0 = UL, Underwriters Laboratories  
 J = CSA, Canadian Standards Association

Example

M452 - 150G - W - 12 - B - V00

Small outdoor model for use with 150 watt metal halide lamp. Latch/hinge mounting plate for recessed outlet box. Green powder coat finish. Integral 277V ballast. UL. Cutoff visor included.

Type: \_\_\_\_\_

Accessories

Order separately. See Accessories Section for specifications.

AEBV | | 0D0 = External vertical blade baffle, black, for lengthwise shielding  
 |  
 2 = 25° shielding  
 4 = 45°

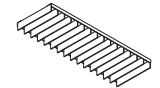

AFK000X | | = Ballast fuse kit  
 |  
 0 = UL  
 J = CSA

