

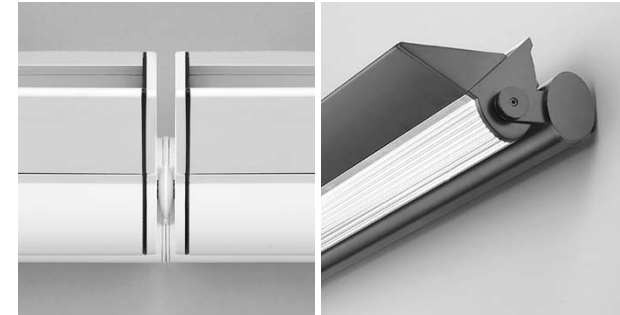

**Wall Mount:** 1:8 Scale

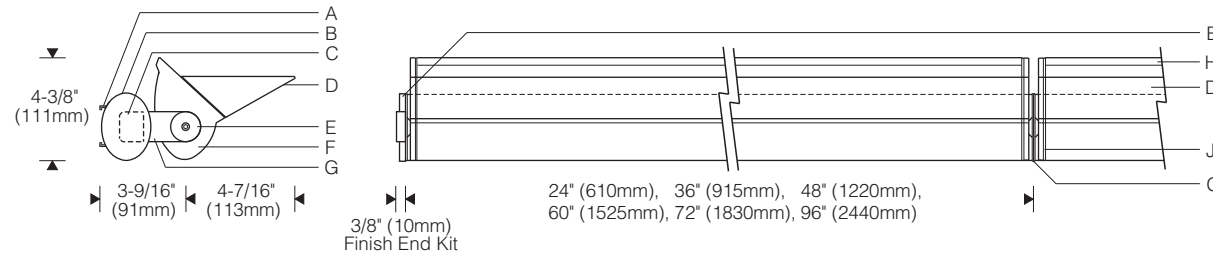

**Mounting Plate**

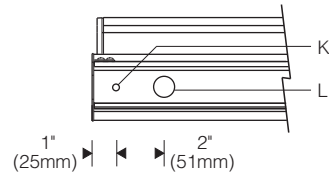

**Installation**

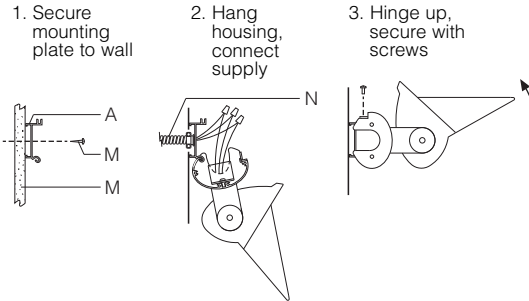

**Base Mount**

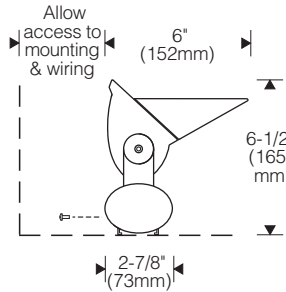

**Specifications**

<b>A</b> Extruded aluminum mounting plate	<b>E</b> AFE finish end kit (includes aluminum end plates and knobs)	<b>H</b> Specular extruded aluminum reflector	<b>L</b> Knockout, (2) 7/8" (22mm) dia.
<b>B</b> Extruded aluminum ballast housing	<b>F</b> Die cast aluminum end plate	<b>J</b> Aluminum reveal plate (black)	<b>M</b> Support structure and fasteners (by others)
<b>C</b> Electronic ballast	<b>G</b> Aluminum sidearm	<b>K</b> Mounting hole, (3) 9/32" (7mm) dia.	<b>N</b> Conduit and connector (by others)
<b>D</b> Extruded aluminum visor			

**Finish:**

*Style 105* fluted - bright clear anodized aluminum housing. Painted end plates, sidearms, visor and ballast housing in choice of silver or semi-gloss black.

*Style 106* smooth - semi-gloss white housing and end plates.

Painted surfaces - 6 stage pretreatment and electrostatically applied thermoset powder coat for stable, long lasting and corrosion resistant finish.

Reflector - extruded high purity aluminum with clear anodized specular finish. All luminaire hardware - stainless steel.

**Mounting:**

Mounting plate fastens flush to wall. Unit hinges on plate for hands-free access to wiring. When mounted in rows, clips are provided to align and space the mounting plates.

**Electrical:**

Use 90°C wire for supply connections and through wire. 7/8" (22mm) dia. knockouts at ends of mounting plate for conduit feed (by others). Accessory end feed kit provides entry for surface conduit at end of ballast housing.

Housing hinges down for access to ballast and wiring. Optional #12 AWG prewired modular through wiring with quick connectors.

Integral electronic HPF thermally protected class P ballast with end-of-life protection.

Optional electronic dimming ballast; compatible dimmer switch required (by others). Consult sales representative for compatibility and specifications.

Optional integral emergency battery operates one lamp. Separate unswitched supply is required.

**Standard:**

UL listed or CSA certified for damp locations. (Style 124 painted model with lens recommended for damp locations.)

**Features**

- Precise optical control of the T5 lamp projects light evenly across the ceiling - offices, conference rooms, lobbies
- Extruded visor, cast end plates join at articulated reveals
- Classic elliptical-shaped ballast housing - hinges on wall plate for easy installation; through wiring for rows
- Optional modular wiring, dimming, emergency battery

**Performance**

Two parabolic reflector sections drive light across the ceiling from one edge. An elliptical section shields the lamp from normal viewing angles and redirects its light to a parabola. Glare is minimized and asymmetry of the beam is maximized resulting in high beam efficiency and superior surface uniformity.

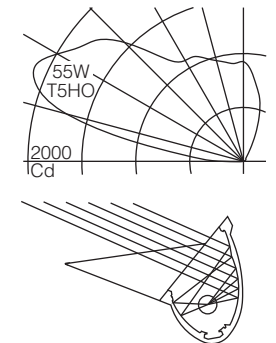

For complete photometrics, visit [www.elliptipar.com](http://www.elliptipar.com)

**elliptipar**



To form a Catalog Number

F | | | | - T | | | | - S | | | | - | | | | - V | | | |  
 1 2 3 4 5 6 7 8

1 Source

F = Linear fluorescent

2 Style

105 = Small fluted surface, integral ballast  
 106 = Small smooth surface, integral ballast

3 Lamp

Note: To order by overall row length, enter ROW CODE (see Row Chart on page C-4.2) in place of Lamp Code below. Row Codes specify a row complete with all necessary luminaires and end plates.

T | | | | = T5 Fluorescent Lamp Code  
 | | | | = Lamp Wattage (see chart below)  
 | | | | = Number of Lamps in Length, specify 1 or 2

Example: T255 = 8' (2.4m) housing with two 54W T5HO lamps (end-to-end)

Length*	T5		T5 HO	
	Code	Lamp(s)	Code	Lamp(s)
T5 Fluorescent				
24" (610mm)	T114	1 x F14T5	T124	1 x F24T5/HO
36" (915mm)	T121	1 x F21T5	T139	1 x F39T5/HO
48" (1220mm)	T128	1 x F28T5	T155	1 x F54T5/HO
60" (1525mm)	T135	1 x F35T5	T180	1 x F80T5/HO
72" (1830mm)	T221	2 x F21T5	T239	2 x F39T5/HO
96" (2440mm)	T228	2 x F28T5	T255	2 x F54T5/HO

For complete lamp and ballast information, see Accessories Section. Standard T5 lamp color is 3000K / 80+ CRI.

\* Add 3/4" (19mm) to row or single unit for AFE Finish End Kit.

4 Mounting

S = Wall (or base) mount

5 Finish

Style 105 Fluted  
 Bright clear anodized reflector with painted components in choice of:  
 01 = Silver  
 81 = Semi-gloss black

Style 106 Smooth  
 02 = Semi-gloss white  
 99 = Custom RAL or computer matched color to be specified, consult sales representative

Project: \_\_\_\_\_

6 Voltage/Ballast

Electronic Dimming \*  
 1 = 120V T = 120V  
 2 = 277V V = 277V  
 3 = 347V (Canada)

\* Consult sales representative for dimming 5' lamps (lamp codes T<sub>x</sub>35, T<sub>x</sub>80). Availability for wattages and voltages varies with ballast manufacturer and control type - see www.elliptipar.com for additional dimming specifications and limitations.

7 Option (See Accessories Section for specifications)

V0 = Cutoff visor included, no other option  
 VE = Integral emergency battery pack with indicator lamp and test button. Available in 4', 5', 6' and 8' units (lamp codes T128, T135, T221, T228, T155, T239 and T255). Operates one lamp.  
 VK = Prewired modular #12 AWG through wiring with quick connectors  
 VC = Combination of emergency battery pack and prewired modular through wiring as described above  
 VX = For modification not listed, include detailed description. Consult factory prior to specification.

Note: Cutoff visor included with all options.

8 Standard

0 = UL, Underwriters Laboratories  
 J = CSA, Canadian Standards Association

Example

F106 - T255 - S - 02 - 1 - VE0

Small smooth surface model for use with two 4' F54T5HO lamps, 96" long housing (not including AFE finish end kit, order separately). Wall or base mounted. Semi-gloss white. Integral 120V electronic ballast. Cutoff visor. Emergency battery pack. UL.

Type: \_\_\_\_\_

Accessories

Order separately. See Accessories Section for specifications.

AFE06 | | | | 0 = Finish end kit, one required for each row or single unit. Adds 3/4" (17mm) to length.  
 02 = White  
 07 = Silver  
 08 = Black



ASC06000 = End feed kit, bracket with 7/8" dia. entry to secure surface conduit



AFK000X | | | | = Ballast fuse kit  
 0 = UL  
 J = CSA



**To order by Row Code - T5 Lamps**

When the Style 105 / 106 small integral T5 fluorescent is run continuously in a **straight** row, **elliptipar** offers the option of specifying and ordering the entire row as one catalog number. Ordering by row eliminates the need to calculate length, type and quantity of reflectors and end plates.

Steps to specify Row Code:

1. Determine Lamp type and select corresponding lamp code (**S**=T5, **V**=T5HO).
2. Determine maximum available length for row and round up to nearest foot. Find nominal row length in chart (col. 1).
3. Determine what lengths/wattages of lamps will be used and select the corresponding lamp combination codes (col. 2).  
**Example:** If only 3' and 4' lamps are to be used on the project, specify row codes ending with **A**, **B** and/or **D** only.
4. If for a given nominal row length a preferred lamp combination is not listed, select the next shorter row that is available in the desired lamp combination.
5. Once the nominal row length and lamp combination has been found in the chart, note the actual overall row length (last column). Also consider if the quantity and lengths of the individual luminaires suit the installation.
6. Enter the four character Row Code in place of the Lamp Code described on page C-4.1. The remainder of the catalog number is formed as shown on page C-4.1.

**3 Row Code**

**Note:** Enter row code in place of Lamp Code described on page C-4.1.

    |    |    |    = Row Code

**Lamp Combination(s)\***

- A** = All nominal 3' lamps
- B** = All nominal 4' lamps
- D** = Nominal 3' and 4' lamps
- F** = Nominal 3' and 5' lamps
- G** = Nominal 4' and 5' lamps

**Nominal Row Length** in feet, between 3' and 50' \*\*

- S** = T5 fluorescent
- V** = T5 HO fluorescent

\* Not all lamp combinations are available for each nominal row length (see chart)

\*\* Nominal row lengths over 50' can be formed by combining shorter row lengths. (Example: a nominal 60' row can be ordered as two nominal 30' rows.)

**Example**

**F106 - S36B - S - 02 - 2 - V00**

Nominal 36' long row of Style 106 small smooth T5 fluorescent using only nominal 4' (28W) lamps. Row includes four nominal 8' reflectors with two 4' lamps, one nominal 4' reflector with one 4' lamp, one **AFE** finish end kit and integral 277V electronic ballasts. Overall row length is 36' 0-3/4".

Nominal Row Length (feet)	Lamp Combination	Nominal 3' Luminaire (1 x nominal 3' lamp)	Nominal 4' Luminaire (1 x nominal 4' lamp)	Nominal 5' Luminaire (1 x nominal 5' lamp)	Nominal 6' Luminaire (2 x nominal 3' lamps)	Nominal 8' Luminaire (2 x nominal 4' lamps)	AFE Finish End Kit	Overall Row Length
3	A	1					1	3' 0-3/4"
4	B		1				1	4' 0-3/4"
5	G			1			1	5' 0-3/4"
6	A				1		1	6' 0-3/4"
7	D	1	1				1	7' 0-3/4"
8	B					1	1	8' 0-3/4"
9	A	1			1		1	9' 0-3/4"
9	G		1	1			1	9' 0-3/4"
10	D		1		1		1	10' 0-3/4"
11	D	1				1	1	11' 0-3/4"
11	F			1	1		1	11' 0-3/4"
12	A				2		1	12' 0-3/4"
12	B		1			1	1	12' 0-3/4"
13	D	1	1		1		1	13' 0-3/4"
13	G			1		1	1	13' 0-3/4"
14	D				1	1	1	14' 0-3/4"
15	A	1			2		1	15' 0-3/4"
15	D	1	1			1	1	15' 0-3/4"
16	B					2	1	16' 0-3/4"
17	D	1			1	1	1	17' 0-3/4"
17	F			1	2		1	17' 0-3/4"
17	G		1	1		1	1	17' 0-3/4"
18	A				3		1	18' 0-3/4"
18	D		1		1	1	1	18' 0-3/4"
19	D	1				2	1	19' 0-3/4"
20	B		1			2	1	20' 0-3/4"
21	A	1			3		1	21' 0-3/4"
21	G			1		2	1	21' 0-3/4"
22	D		1		3		1	22' 0-3/4"
23	D	1	1			2	1	23' 0-3/4"
23	F			1	3		1	23' 0-3/4"
24	A				4		1	24' 0-3/4"
24	B					3	1	24' 0-3/4"
25	D	1			1	2	1	25' 0-3/4"
25	G		1	1		2	1	25' 0-3/4"
26	D		1			1	2	26' 0-3/4"
27	D	1				3	1	27' 0-3/4"
28	B		1			3	1	28' 0-3/4"
29	D	1	1			1	2	29' 0-3/4"
29	G			1		3	1	29' 0-3/4"

Nominal Row Length (feet)	Lamp Combination	Nominal 3' Luminaire (1 x nominal 3' lamp)	Nominal 4' Luminaire (1 x nominal 4' lamp)	Nominal 5' Luminaire (1 x nominal 5' lamp)	Nominal 6' Luminaire (2 x nominal 3' lamps)	Nominal 8' Luminaire (2 x nominal 4' lamps)	AFE Finish End Kit	Overall Row Length
30	A				5		1	30' 0-3/4"
30	D				1	3	1	30' 0-3/4"
31	D	1	1			3	1	31' 0-3/4"
32	B					4	1	32' 0-3/4"
33	A	1			5		1	33' 0-3/4"
33	G		1	1		3	1	33' 0-3/4"
34	D		1		1	3	1	34' 0-3/4"
35	D	1				4	1	35' 0-3/4"
36	A				6		1	36' 0-3/4"
36	B		1			4	1	36' 0-3/4"
37	D	1	1		1	3	1	37' 0-3/4"
37	G			1		4	1	37' 0-3/4"
38	D				1	4	1	38' 0-3/4"
39	D	1	1			4	1	39' 0-3/4"
40	B					5	1	40' 0-3/4"
41	D	1			1	4	1	41' 0-3/4"
41	G		1	1		4	1	41' 0-3/4"
42	A				7		1	42' 0-3/4"
42	D		1		1	4	1	42' 0-3/4"
43	D	1				5	1	43' 0-3/4"
44	B		1			5	1	44' 0-3/4"
45	A	1			7		1	45' 0-3/4"
45	D	1	1		1	4	1	45' 0-3/4"
45	G			1		5	1	45' 0-3/4"
46	D				1	5	1	46' 0-3/4"
47	D	1	1			5	1	47' 0-3/4"
48	A				8		1	48' 0-3/4"
48	B					6	1	48' 0-3/4"
49	D	1			1	5	1	49' 0-3/4"
49	G		1	1		5	1	49' 0-3/4"
50	D				3	4	1	50' 0-3/4"

**Features**

- Time saving - simplifies specification and ordering
- One catalog number - includes all necessary reflectors to install row plus **AFE** finish end kit
- Assured fit - all you need is the maximum available length of the wall

For complete photometrics, visit [www.elliptipar.com](http://www.elliptipar.com)

**elliptipar**

