

**Wall Mount:** 1:8 Scale

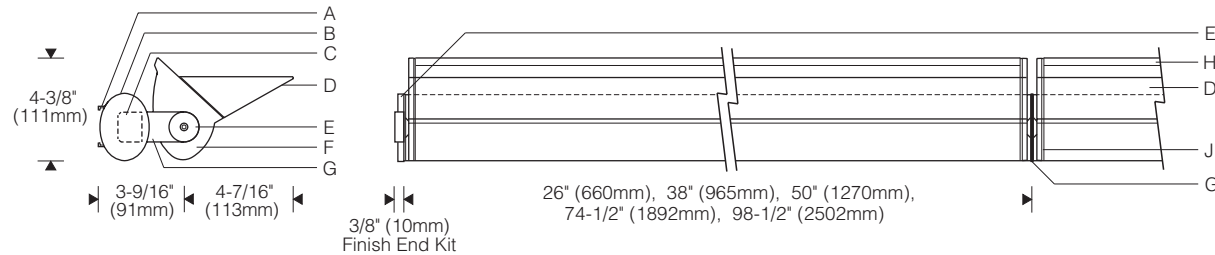

**Mounting Plate**

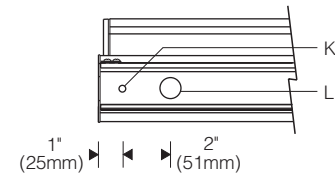

**Installation**

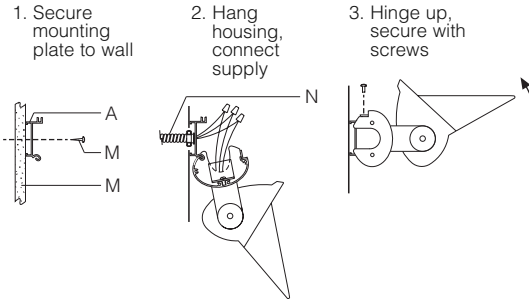

**Base Mount**

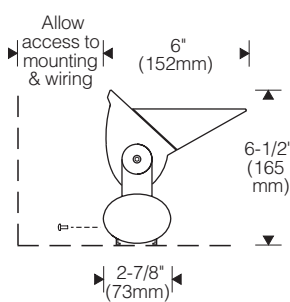

**Specifications**

<b>A</b> Extruded aluminum mounting plate	<b>E</b> AFE finish end kit (includes aluminum end plates and knobs)	<b>H</b> Specular extruded aluminum reflector	<b>L</b> Knockout, (2) 7/8" (22mm) dia.
<b>B</b> Extruded aluminum ballast housing	<b>F</b> Die-cast aluminum end plate	<b>J</b> Aluminum reveal plate (black)	<b>M</b> Support structure and fasteners (by others)
<b>C</b> Electronic ballast	<b>G</b> Aluminum sidearm	<b>K</b> Mounting hole, (3) 9/32" (7mm) dia.	<b>N</b> Conduit and connector (by others)

**Features**

- Adjustable reflector with T8 lamp projects light evenly across the ceiling – offices, conference rooms, lobbies
- Extruded visor, cast end plates join at articulated reveals
- Classic elliptical-shaped ballast housing – hinges on wall plate for easy installation; through wiring for rows
- Optional modular wiring, dimming, emergency battery

**Performance**

Two parabolic reflector sections drive light across the ceiling from one edge. An elliptical section shields the lamp from normal viewing angles and redirects its light to a parabola. Glare is minimized and asymmetry of the beam is maximized resulting in high beam efficiency and superior surface uniformity.

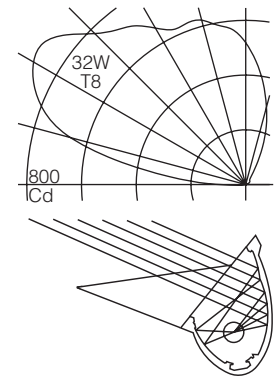

For complete photometrics, visit [thelightingquotient.com](http://thelightingquotient.com)

**Finish:**

Style 105 fluted – bright clear anodized aluminum housing. Painted end plates, sidearms, visor and ballast housing in choice of silver or semi-gloss black.

Style 106 smooth – semi-gloss white housing and end plates.

Painted surfaces – 6 stage pretreatment and electrostatically applied thermoset powder coat for stable, long lasting and corrosion resistant finish.

Reflector – extruded high purity aluminum with clear anodized specular finish. All luminaire hardware – stainless steel.

**Mounting:**

Mounting plate fastens flush to wall. Unit hinges on plate for hands-free access to wiring.

**Electrical:**

Use 90°C wire for supply connections and through wire. 7/8" (22mm) dia. knockouts at ends of mounting plate for conduit feed (by others). Accessory end feed kit provides entry for surface conduit at end of ballast housing.

Housing hinges down for access to ballast and wiring. Optional #12 AWG prewired modular through wiring with quick connectors.

Integral electronic HPF thermally protected class P ballast.

Optional electronic dimming ballast dims to 5% of full light output. Compatible dimmer switch is required (by others). Consult local sales representative for specifications.

Optional integral emergency battery operates one lamp. Separate unswitched supply is required.

**Standard:**

UL listed or CSA certified for damp locations (Style 151 is painted model with lens recommended for damp location use; see Outdoor section).



**To form a Catalog Number**

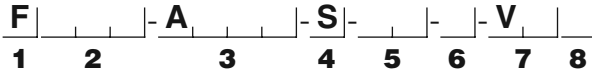

**1 Source**

F = Linear fluorescent

**2 Style**

105 = Small fluted surface, **integral** ballast  
 106 = Small smooth surface, **integral** ballast

**3 Lamp**

A | | | | = T8 Fluorescent Lamp Code

Lamp Wattage (see chart below)

Number of Lamps in Length, specify 1 or 2

Example: **A225** = one nominal 6' reflector with two 25W T8 lamps; one 2-lamp ballast

Lamp Code	Luminaire Length*	Lamp(s)
T8 Fluorescent		
<b>A117</b>	26" (661mm)	1 x F17T8
<b>A125</b>	38" (966mm)	1 x F25T8
<b>A132</b>	50" (1270mm)	1 x F32T8
<b>A225</b>	74-1/2" (1893mm)	2 x F25T8
<b>A232</b>	98-1/2" (2502mm)	2 x F32T8

For complete lamp and ballast information, see Accessories Section. T8 lamp not included.

\*Add 3/4" (19mm) to row or single unit for **AFE** Finish End Kit.

**4 Mounting**

S = Wall (or base) mount

**5 Finish**

Style 105 Fluted

Bright clear anodized reflector with painted components in choice of:

01 = Silver  
 81 = Semi-gloss black

Style 106 Smooth

02 = Semi-gloss white

99 = Custom RAL or computer matched color to be specified, consult sales representative

Project: \_\_\_\_\_

**6 Voltage/Ballast**

Electronic

1 = 120V  
 2 = 277V  
 3 = 347V (Canada)

Dimming\*

T = 120V  
 V = 277V

**7 Option** (see Accessories Section for specifications)

**VO** = Cutoff visor included, no other option  
**VE** = Integral emergency battery pack with indicator lamp and test button. Not available for **A117** lamp code. Operates one lamp.  
**VK** = Prewired modular #12 AWG through wiring with quick connectors  
**VC** = Combination of emergency battery pack and prewired modular through wiring as described above  
**VX** = For modification not listed, include detailed description. Consult factory prior to specification.

**Note:** Cutoff visor included with all options.

**8 Destination Requirement**

0 = UL listed or CSA certified for U.S.  
 J = UL listed or CSA certified for Canada

**Example**

**F105 - A232 - S - 02 - 1 - VE0**

Small fluted surface model for use with two 4' F32T8 lamps, 98-1/2" long housing (not including **AFE** finish end kit, order separately). Wall mounted. Semi-gloss white. Integral 120V electronic ballast. Emergency battery pack. UL listed or CSA certified for U.S.

Type: \_\_\_\_\_

**Accessories**

Order separately. See Accessories Section for specifications.

**AFE06** | | | | **0** = **Finish end kit**, one required for each row or single unit. Adds 3/4" (19mm) to length.

02 = White  
 07 = Silver  
 08 = Black



**ASC06000** = **End feed kit**, 7/8" dia. entry for surface conduit



**AFK000X** | | | | = Ballast fuse kit

0 = U.S.  
 J = Canada

