

Style F164 1:8 Scale

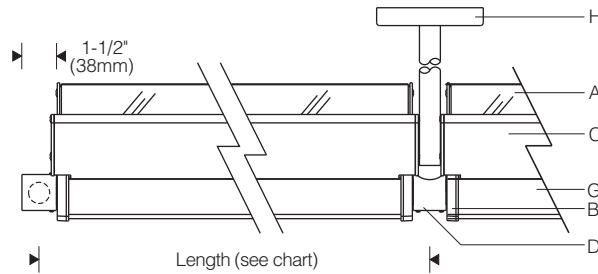

Pendant Hanger

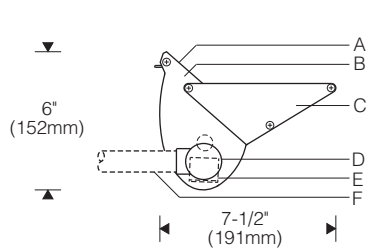
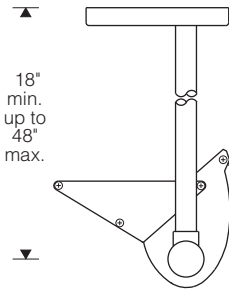

Surface Hanger

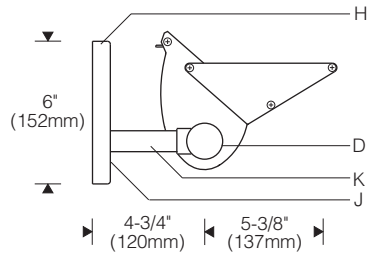

Mounting Plate

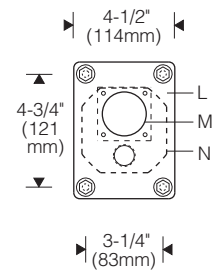

Cove* 1:10 Scale

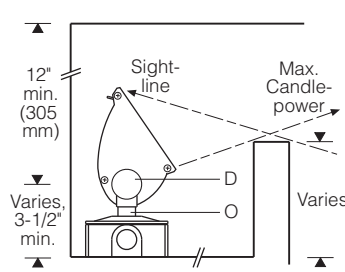

Lamp Length	Length (center to center of hubs)
1 x 2'	25-1/4" (640mm)
1 x 3'	37" (940mm)
1 x 4'	48-3/4" (1240mm)
1 x 5'	60-5/8" (1540mm)
2 x 3'	72" (1830mm)
2 x 4'	96" (2440mm)

*For cove design guidance, see Applications Section

Specifications

- A** UV and impact resistant acrylic snap-on lens with silicone gasket
- B** Die-cast aluminum end plates
- C** Extruded aluminum visor with stamped end plates
- D** Aluminum hubs with silicone o-ring gaskets (ordered separately)
- E** Integral electronic ballast / internal wireway
- F** 1/2" rigid conduit supports (by others)
- G** Specular extruded aluminum reflector
- H** Surface or pendant hangers with hubs (ordered separately)
- J** Aluminum cover (conceals fasteners)
- K** Tubular steel arm or stem
- L** Aluminum mounting plate
- M** Access with gasketed cover (electrical feed)
- N** Recessed outlet box
- O** 1/2" fittings (by others)

Finish:

Exterior surfaces - 6 stage pretreatment and electrostatically applied thermoset polyester powder coating for a durable abrasion, fade and corrosion resistant finish. Choice of semi-gloss colors (see ordering information).

Reflector - extruded high purity aluminum with clear anodized specular finish. All hardware and components - non corrosive stainless steel or aluminum.

Snap-on lens - composite of impact resistant and UV stabilized acrylic. Silicone gasket for watertight operation.

Electrical:

Use 90°C wire for supply connections and through wire.

Electrical feed hanger (optional) mounts over recessed outlet box (by others) with gasketed access cover. Internal wireway allows supply wiring to be fed through mounting hub to adjacent units. Locate electrical feed at end of row.

Integral electronic HPF thermally protected class P ballast rated for 0°F/-18°C starting.

For complete ballast specifications, see Accessories Section.

Mounting:

1-1/2" dia. x 1-1/2" aluminum hubs with 1/2" NPT threaded entry. Reflector aiming is adjustable - locks with set screws. Specify with hubs only for use with 1/2" rigid conduit or fittings supplied by others.

Optional accessory surface or pendant hangers (ordered separately). Hangers include die-cast aluminum mounting plate, aluminum cover and hub with 7/8" O.D. steel arm/stem (1/4-20 fasteners by others). Suitable backing structure required - allow 3 lbs/ft (21.6kg/m) (8' unit = 24 lbs). Specify end kit or intermediate hubs/hangers.

Standard:

UL listed or CSA certified for wet locations when mounted horizontally. For positions other than horizontal, consult factory.

Features

- Reflector optimized for T5 - upright canopies, vaults, soffits with unequalled uniformity from minimal setbacks
- Secure snap-on UV resistant acrylic lens - easy to relamp
- Extruded visor provides shielding - concealed drainage
- Polyester powder coat - exceeds 1000 hour salt spray test
- Integral electronic ballast - internal wireway for thru wiring

Performance

Two parabolic reflector sections drive light across the overhead plane from one edge. An elliptical section redirects its light to a parabola and shields the lamp. Asymmetry is maximized resulting in high beam efficiency and superior surface uniformity. The fast "runback" minimizes wasted spill light.

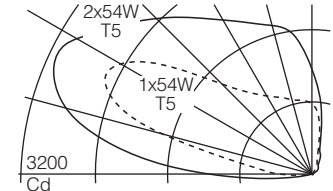

Adjustable - max. Cd shown aimed 25° above horizontal.

Note: Lamp light output may be diminished when operated in low ambient temperatures.

For complete photometrics, visit www.elliptipar.com



