

**gondolier**<sup>®</sup>  
store lighting system





### lighting with *punch*

Put the focus on the merchandise.  
**gondolier's** high performance asymmetric reflector projects light from the top of a display to the bottom from a height of 7' or more.

Available in modules to fit your design with arms that hook into the slotted uprights or set into the posts.

Add MR-16s for highlighting or a wall uplight to illuminate signage above the display.

Add a symmetric reflector to the top of the gondolier for uplighting and eliminate lights in the ceiling.

The complete store lighting system ...  
 that's **gondolier!**

**U. S. patent nos. 6,270,232; 6,431,721;  
 foreign and other patents pending.**

### a bold new modular system

- slim profile
- standard gondola and display lengths
- three reflector styles - fluted, smooth and contoured in bright aluminum or thermoset powdercoat [choice of RAL colors]
- choice of arm styles and lengths
- locked aiming
- optional snap-in cross baffles for added shielding
- optional snap-on lens
- optional MR-16 accentlight kit for highlighting
- optional T5 wall uplight kit lights signage above
- through-wiring from one feed or cord and plug
- quiet, energy efficient electronic ballast
- meets or exceeds ASHRAE/IESNA Standard 90.1 for energy use

### energy efficient T5 fluorescent in the elliptipar asymmetric reflector



- drives the light to the bottom shelf
- lamps are shielded from the shopper's normal view



- long lamp life - up to 20,000 hours [2-1/2 years at 24 hours per day]
- relamp from the floor - *bye, bye ladders!*



- excellent color rendering
- lamps available in warm 3000K, neutral 3500K and cool 4100K

# a complete store lighting system...

versatile...add accentlights, wall uplights and indirect ambient lighting



**500 Contoured**  
reflector shown in semi-gloss white finish with solid arm



**501 Fluted**  
shown in bright and black finish with black slotted arm



**502 Smooth**  
reflector shown in semi-gloss white finish with solid arm



**502 Smooth**  
reflector shown in semi-gloss brown finish with solid arm

Custom colors, too!



- can be through-wired from a single feed point
- optional uplight provides glare-free ambient illumination

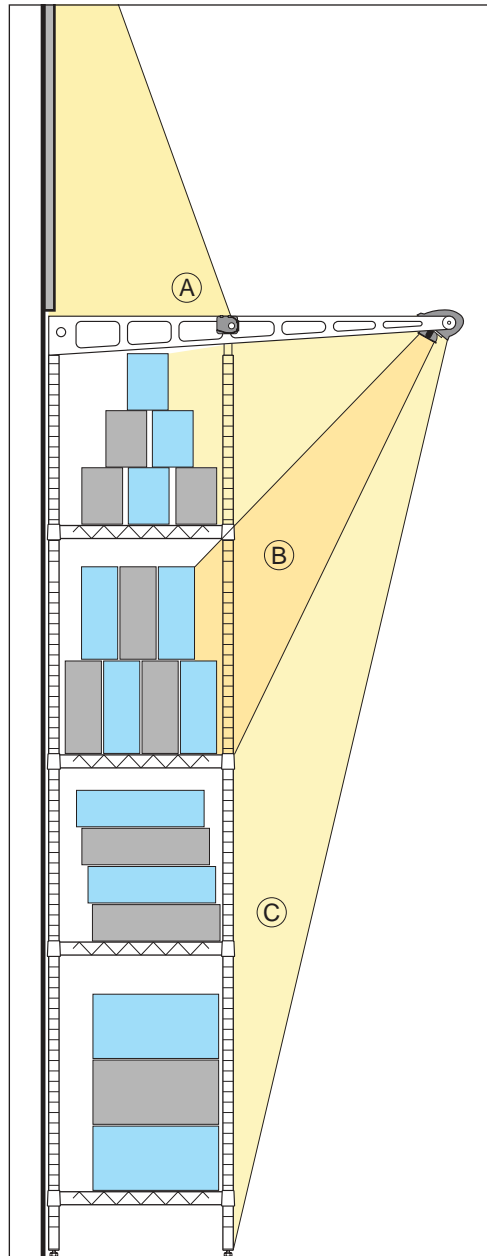

Wall uplight illuminates signage or graphics above the display.



Accent light creates sparkle and warm highlights on featured items. Two MR-16 spot lamps in gimbel rings snap into the reflector. **Patents pending**



Asymmetric reflector drives light to the bottom.

...can even eliminate overhead lighting!

simple to install,  
easy to rearrange

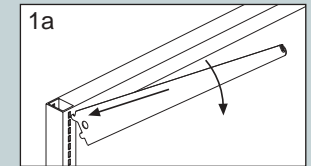

**Slotted shelf standards:**  
insert tabs on **gondolier** arm into slots of upright. Swing arm down to lock.

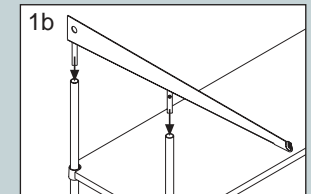

**Wire shelving:**  
set **gondolier** arms into tops of posts.

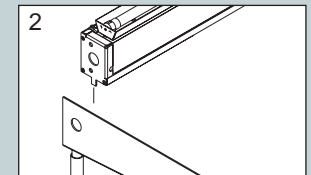

Lower ballast box onto arms and connect ballast to supply wiring. (Shown with symmetric uplight module.)

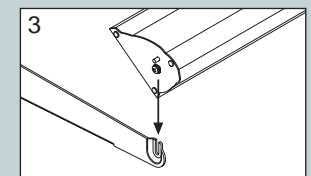

Install reflector onto arms and connect lamp wires to ballast. Close ballast box cover. For rows, repeat above steps - adjacent units can be through-wired.

# to complete the design...

**elliptipar** offers a full line of asymmetric luminaires to light perimeter walls, displays and signs.

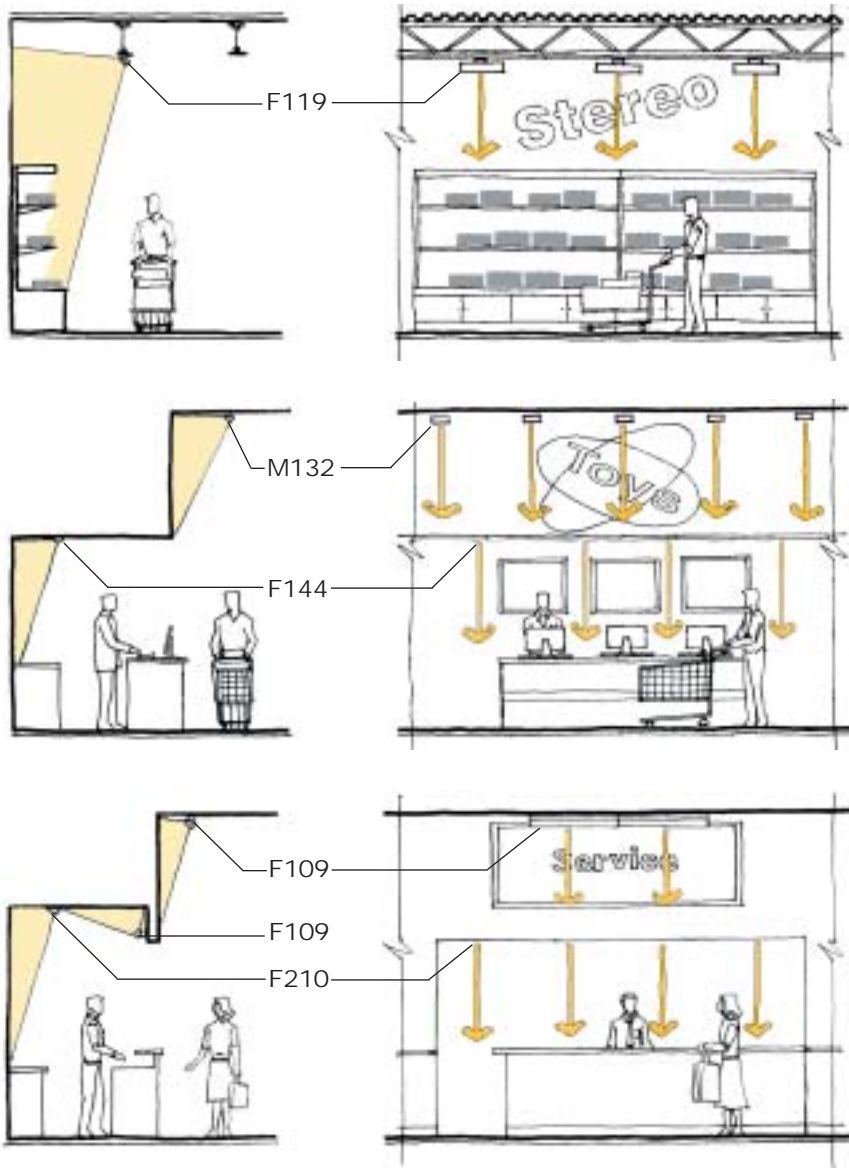

**Style F119 4X®  
long twin tube fluorescent**

universal track or ceiling mounted for high impact wall, display and merchandise lighting; cantilever for sign lighting



**Style M132  
ceramic metal halide**

powerful, low energy wall lighting with excellent color rendering, long life; surface, pendant, track or cantilever mount; integral electronic ballast



**Style F144  
T5 fluorescent**

low profile semi-elliptical form, adjustable; easy to install alternative to slot; great lighting for wall displays.

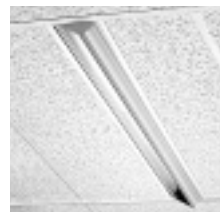

**Style F210  
T5 fluorescent**

semi-recessed, low profile, adjustable; only 5" wide slot; perfect for lighting slat wall displays and notice/marker boards



**Style F109 Ovalinear®  
T5/ T8 fluorescent**

surface, cantilever or pendant mount to uplight/wallwash perimeter walls, signage, graphics; optional parabolic baffle or cutoff visor for additional shielding



... there is no equal™

To view our complete line of luminaires and project photography, visit our website at: [www.elliptipar.com](http://www.elliptipar.com)

114 Boston Post Road  
West Haven, CT 06516  
203.931.4455  
Fax: 203.931.4464  
[www.elliptipar.com](http://www.elliptipar.com)